

Turning off Private Browsing on Pupils' iPads

1. Open Safari

To determine whether or not **Private Browsing** is enabled, look at the address bar at the top of the browser. If it is **white**, then Private Browsing is turned off. If it is **black**, then Private Browsing is turned on:

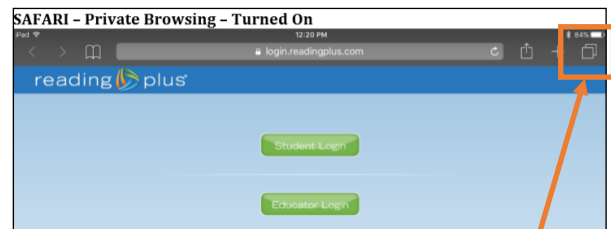

If you find that a pupil has the Private Browsing turned on, follow the steps below to turn it off.

2. Locate the two squares in the upper right corner of the screen.



3. Press the two boxes and you should see a screen like this one.

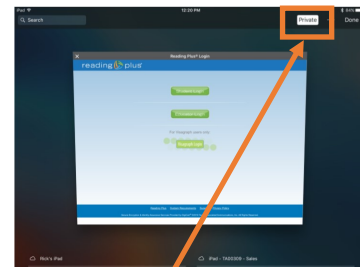

4. Click on the word 'Private' in the upper right corner to unselect, followed by **Done**.

